

# CONTROL PRODUCTS

## IP66 Control Station Enclosures

ABS enclosures pre-drilled with 22mm holes for the mounting of pushbutton switches

- IP66 sealed
- 21mm diameter knockouts with PG13.5 thread for cable glands
- Black base with yellow lid
- Wall mountable via secure screws in base/cable tie clamp
- Captive plastic screws

### SPECIFICATIONS

Materials	ABS UL94-V0
Protection Class	IP66
Rated Temperature	from -25°C to +70°C
Standard Colours	Lid- Yellow (RAL 1023) Black (RAL 9017)

### Empty Enclosures

TYPE NO	HOLES	LID COLOUR	LENGTH	WIDTH	HEIGHT
SC1A	1	Yellow	85	70	65
SC2A	2	Yellow	117	70	65
SC3A	3	Yellow	150	70	65

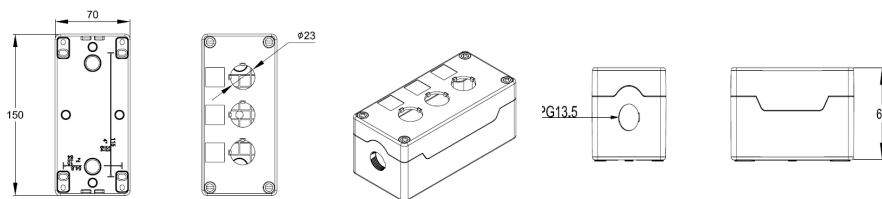
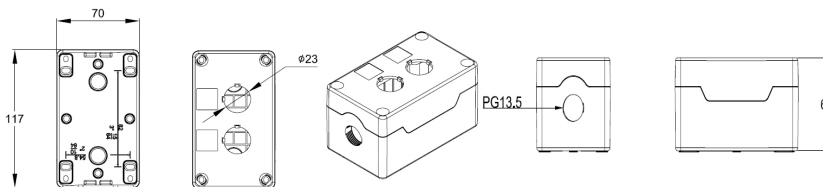
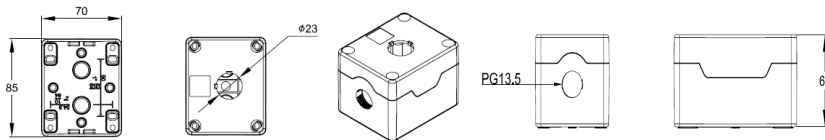

PCB  
TERMINAL  
BLOCKS

INTER-  
CONNECTION

FUSES &  
FUSE-  
HOLDERS

LEDs &  
INDICATORS

MINIATURE  
SWITCHES

LIMIT &  
SAFETY  
SWITCHES

CONTROL  
PRODUCTS

INTERFACE  
MODULES &  
SUPPORTS

RELAY  
BASES

ENCLOSURES

BATTERIES

TRANS-  
FORMERS