

OVERALL ASSEMBLY DIMENSIONS:

EXTERNAL - 222.5 x 145.8 x 82.2

INTERNAL - 216.5 x 139.8 x 76.5

- (1) 6x M4 UNIT ASSEMBLY SCREW
- (2) 2x SELF-TAPPING INTERNAL MOUNTING SCREW

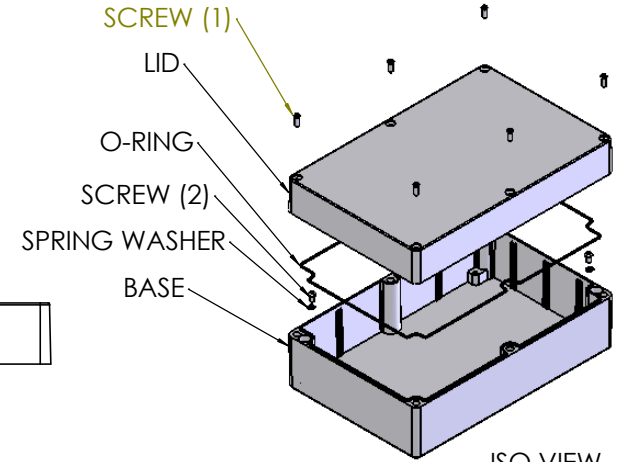

ISO VIEW
1:6

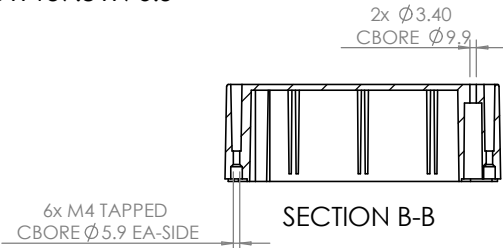

SECTION B-B

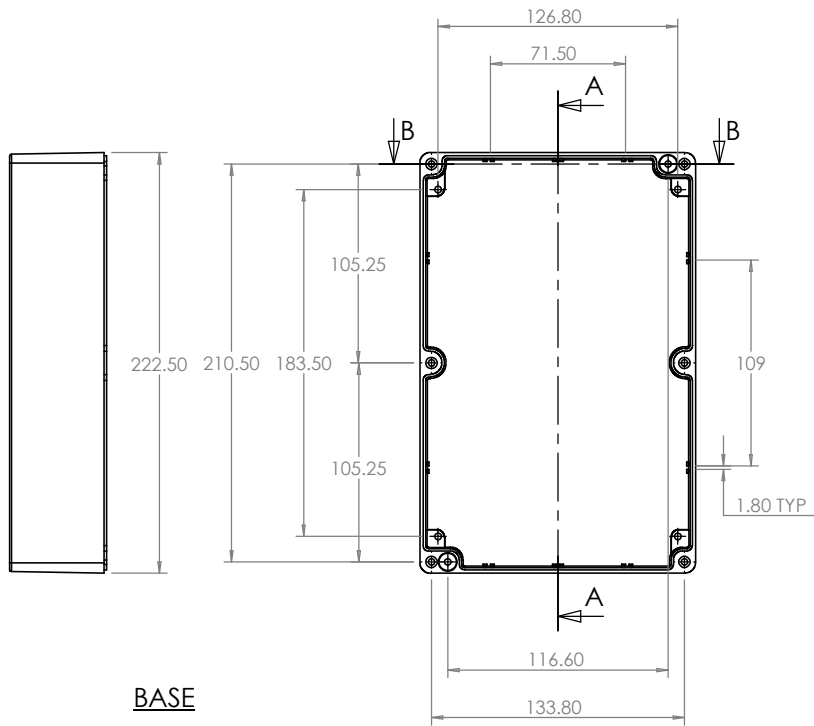

BASE

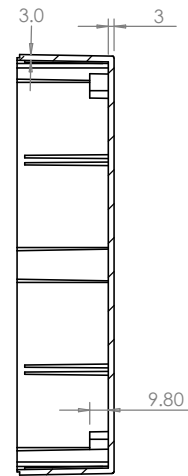

SECTION A-A

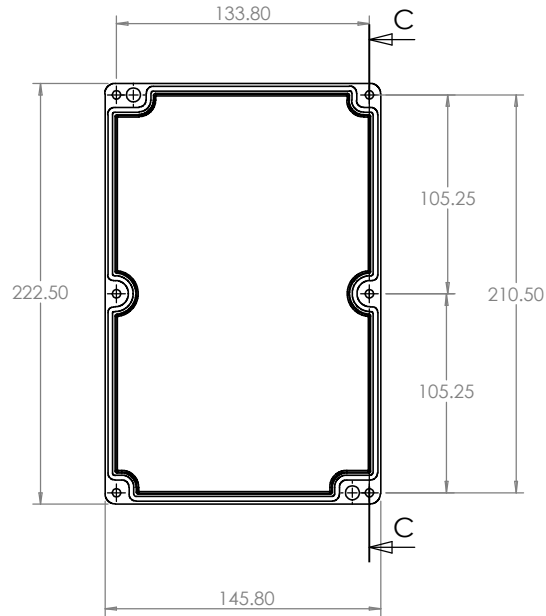

LID

SECTION C-C

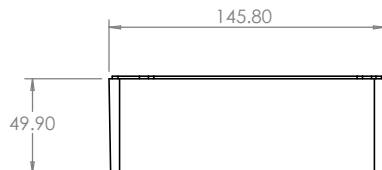

 JAMES CARTER RD, MILDENHALL, SUFFOLK. IP28 7DE TEL: 01638 716101 FAX: 01638 716554 EMAIL: Sales@CamdenBoss.com WEB: www.CamdenBoss.com		UNLESS OTHERWISE SPECIFIED: DIMENSIONS ARE IN MILLIMETERS		DO NOT SCALE DRAWING	REVISION. 0
		FINISH: SMOOTH		TITLE: ASSEMBLY DRG FOR 5500-25	
DRAWN	S.HARDINGE	SIGNED	SJH	DATE	10/01/06
CHK'D	-	-	-	MATERIAL: DIE-CAST ALUMINIUM	DWG NO. 5500-25
PROJECTION.				SCALE: 1 : 4	SHEET 1 OF 1
					A4